

IMPORTANT SAFEGUARDS READ AND FOLLOW ALL SAFETY INSTRUCTIONS.

When using electrical equipment, basic safety precautions should always be followed including the following:

- **DISCONNECT AC POWER SUPPLY BEFORE SERVICING.**
- Installation and servicing of this equipment should be performed by qualified service personnel only.
- Ensure that the electrical wiring conforms to the National Electrical Code NEC® and local regulations if applicable.
- Do not mount near gas or electrical heaters.
- Do not use outdoors.
- Equipment should be mounted in locations and at heights where it will not be readily subjected to tampering by unauthorized personnel.
- The use of accessory equipment not recommended by the manufacturer may cause an unsafe condition.
- Any modification or use of non-original components will void the warranty and product liability.
- Do not use this equipment for other than intended use.
- Allow battery to charge for 24 hours before first use.

SAVE THESE INSTRUCTIONS!

1. Remove the (2) screws from the trim plate assembly and detach from the back box.
2. Carefully remove the LED indicator light and the ground wire from the trim plate and disconnect the wire harness.
3. Select the desired mounting area, taking into consideration accessibility to perform installation.
4. Place the provided template against the mounting surface where the RM2 will be installed and trace the outer edge. Use this outline to cut the hole for the back box.

Caution: Live wires, conduit or water pipes may be present.

5. Remove the necessary knockout for routing wires. Fig. 1
6. Mount the back box in place using the provided hanger bars. Fig. 2
7. Adjust the brackets until the bottom of the back box is even with the mounting surface and tighten to hold in place. Fig 3.
8. Make AC connections per "**Wiring Section**".

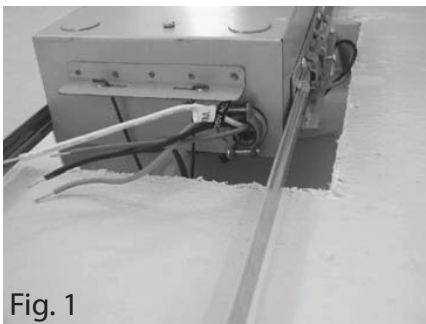

Fig. 1

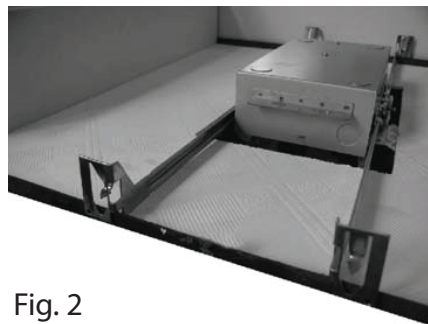

Fig. 2

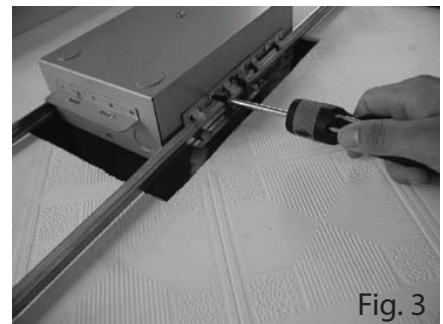

Fig. 3

9. Reattach the trim plate assembly to the back box by pinching together the spring clips and hooking them into the slots located on the outside of the back box.

10. Carefully reconnect the LED indicator light, ground wire, wire harness and battery connections.

Warning: Connect battery only after continuous AC power can be provided to the unit.

11. Secure the trim plate assembly to the back box with the two screws (removed in step 1).
Adjust the lamp heads to the desired orientation.

WIRING

Make electrical connections as follows:

- White - Common
- Black - 120VAC
- Orange/Red - 277VAC

Important: Electrical connections should be made inside junction box (supplied by others).

Caution: Failure to cap unused wires may result in shock hazard or unsafe condition as well as equipment failure.

WIRING DIAGRAM

